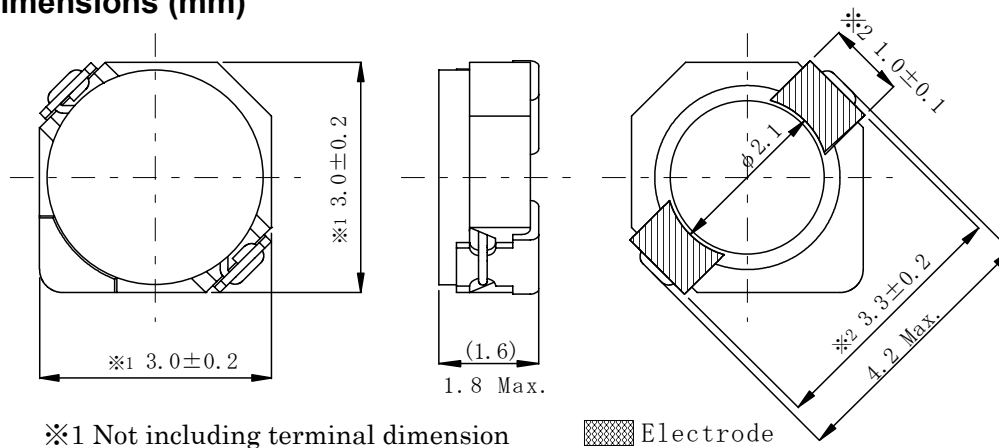
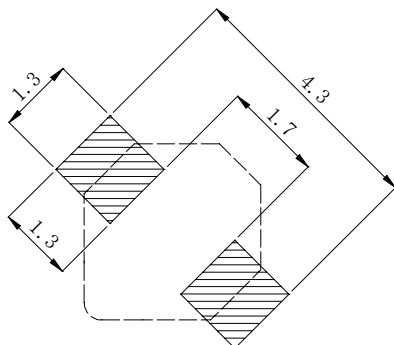

**Type: CDRH2D16/LD**
**◆ Product Description**

- 3.2×3.2mm Max.(L×W), 1.8mm Max. Height.
- Inductance range: 2.2~27μH.
- Rated current range: 0.26~0.86 A.
- In addition to the standards versions shown here, custom inductors are also available to meet your exact requirements.

**◆ Feature**

- Magnetically shielded construction.
- Ideally used in Mobilephone, PDA, MP3, DSC/DVC, etc as DC-DC Converter inductors.
- RoHS Compliance.

**◆ Dimensions (mm)**

**◆ Land Pattern (mm)**

**Type: CDRH2D16/LD**
**◆ Specification**

Part Name ※	Stamp	Inductance ( $\mu$ H) [Within] 100kHz/1V	D.C.R.(m $\Omega$ ) Max.(Typ.) (at 20°C)	Saturation current (A)※1		Temperature rise current (A)※2
				(at 20°C)	(at 100°C)	
CDRH2D16LDNP-2R2N□	A	2.2 $\pm$ 30%	47(38)	0.86	0.65	2.20
CDRH2D16LDNP-2R7N□	B	2.7 $\pm$ 30%	61(49)	0.82	0.60	1.90
CDRH2D16LDNP-3R3N□	C	3.3 $\pm$ 30%	67(54)	0.72	0.52	1.74
CDRH2D16LDNP-3R9N□	D	3.9 $\pm$ 30%	75(60)	0.70	0.48	1.60
CDRH2D16LDNP-4R7N□	E	4.7 $\pm$ 30%	101(81)	0.62	0.45	1.32
CDRH2D16LDNP-5R6N□	F	5.6 $\pm$ 30%	123(98)	0.57	0.40	1.25
CDRH2D16LDNP-6R8N□	G	6.8 $\pm$ 30%	158(127)	0.50	0.35	1.00
CDRH2D16LDNP-8R2N□	H	8.2 $\pm$ 30%	171(137)	0.45	0.33	0.95
CDRH2D16LDNP-10 $\emptyset$ N□	I	10.0 $\pm$ 30%	195(156)	0.42	0.30	0.92
CDRH2D16LDNP-12 $\emptyset$ N□	J	12.0 $\pm$ 30%	223(179)	0.39	0.28	0.85
CDRH2D16LDNP-15 $\emptyset$ N□	K	15.0 $\pm$ 30%	248(198)	0.35	0.26	0.81
CDRH2D16LDNP-18 $\emptyset$ N□	L	18.0 $\pm$ 30%	316(252)	0.32	0.23	0.73
CDRH2D16LDNP-22 $\emptyset$ N□	M	22.0 $\pm$ 30%	418(335)	0.28	0.21	0.60
CDRH2D16LDNP-27 $\emptyset$ N□	N	27.0 $\pm$ 30%	466(373)	0.26	0.18	0.53

**※ Description of part name**

CDRH2D16LDNP-2R2N□

— B Box

— C Carrier Tape

※1.Saturation Current: The DC current at which the inductance decreases to 65% of it's nominal value

 ※2 Temperature rise current: The DC current at which the temperature rise is  $\Delta t=40^{\circ}\text{C}$ .( $T_a=20^{\circ}\text{C}$ )